



Compressor
Voltage Code : XG

FH2511Z-XG1A

Low Temp. Commercial (BP)

380-420V 3~ 50Hz / 460V 3~ 60 Hz

R452A / R404A / R448A / R449A

FH2511ZXG1A

Conditions	Frequency	Nominal Cooling Capacity		Sound Power ISO3745 / ISO 3743-1
		Watts	BTU/h	
EN12900 / R452A	50 Hz / 60 Hz	1495 / 1652	5097 / 5634	74 dBA
EN12900 / R404A	50 Hz / 60 Hz	1671 / 1846	5696 / 6296	74 dBA
EN12900 / R448A	50 Hz / 60 Hz	1309 / 1447	4463 / 4933	74 dBA
EN12900 / R449A	50 Hz / 60 Hz	1309 / 1447	4463 / 4933	74 dBA

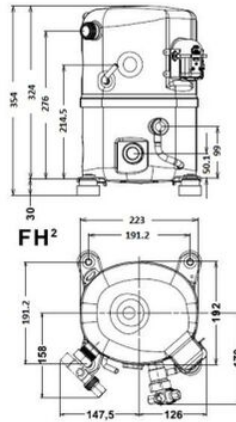

Displacement (cc)	68.0
Net Weight (Kg)	30.0
Oil Quantity (cc)	1140.0
Oil Type	Polyolester
Expansion Device	Capillary_Tube/Expansion_Valve
Cooling	Fan
Main Winding (Ohm)	9.2
Current	
RLA (A)	4.2 4
MCC (A)	8.3
LRA (A)	60
Electrical Equipment	TRI
Overload	Interne
Refrigerating connection for OD	
Suction Tube	15.9 (5/8")
Discharge Tube	12.7 (1/2")
Process Tube	6.35 (1/4")

* EN12900 : T*Cond. 40.0°C / T*Evap. -35.0°C / T*Return gas temp. 20.0°C
T*Subcooling, 0.0K

Certificates :



Note : Tecumseh reserves the right to change information contained in this document without notification.